

Wine & Garden Tour

Self Drive Itinerary



**Estimated
Timing**

45 minute visit

Domaine de Chaberton

1064 - 216 Street, Langley, BC 1-888-332-9463
The first and largest Estate Winery in the Fraser Valley. This vineyard excels in "cool climate vitis Vinifera" grapes, producing over 50,000 cases of white wine each year. Enjoy a behind the scenes tour and tasting of some of our delicious wines—scheduled wine tours are available for \$3/ person, call for times. Tastings available at any time.
www.domainedechaberton.com
info@domainedechaberton.com
Monday to Saturday 10am to 6pm, Sunday 11am to 6pm



45 minute travel

2 hour visit
(w/lunch)

Minter Gardens

Exit #135 off Hwy #1, Chilliwack BC 1-888-MINTERS
A world class 32 acre show garden, featuring 11 themed gardens, designed to dazzle the senses with fragrance and colour. A great place for the whole family to enjoy the beauty of the outdoors. Be sure to stop in one of our two restaurants for a delicious lunch.
Entry rates applicable: Adults \$15, Seniors \$12.50, Kids \$6 to \$9, Tots Free
www.mintergardens.com mail@mintergardens.com
Open daily March 23—October 13, 2008, 10am-5pm
July & August open until 7pm

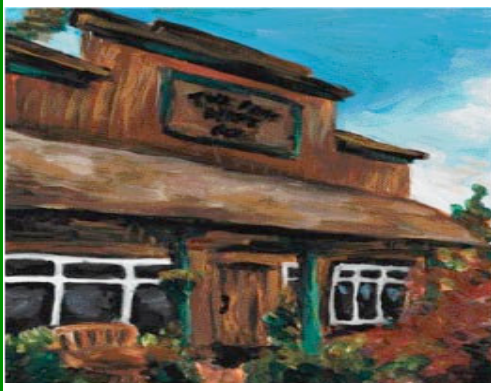

45 minute travel

45 minute visit

The Fort Wine Company

26151 84th Avenue, Fort Langley, BC 1-866-921-WINE
Travel back in time as you step right up to an old-fashioned saloon bar to sample a delicious selection of multi-award winning table and dessert fruit wines. A guided tour will show you our wine making process and tastings are always available.
www.thefortwineco.com fwcweb@thefortwineco.com
Open daily 10 am until 6 pm



10 minute travel

45 minute visit

Historical Village of Fort Langley

Fort Langley offers a wide range of progressive shops in a relaxed historic setting. Our merchants provide high quality products, specialty items and personalized service making the commercial core a destination for residents and visitors.
www.fortlangley.com



Itinerary Locations

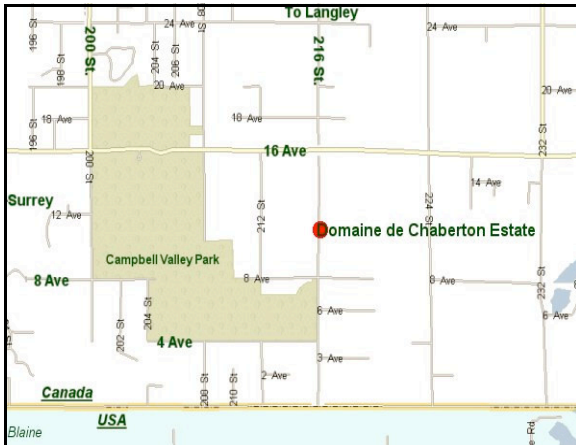

Domaine de Chaberton

- From Vancouver, travel east on Hwy #1
- Take exit #58 on to 200 Street and exit onto (far right hand lane) heading south.
- Proceed to 72 Avenue and make a left, proceed on 72 Avenue (which becomes Crush Crescent) and then 216 Street (after railway tracks).
- Continue heading South on 216 Street (passed the Langley Airport) until you reach 16th Avenue. Cross 16th Avenue. The winery will be on your left.
- 1064 - 216 Street, Langley, BC 1-888-332-9463

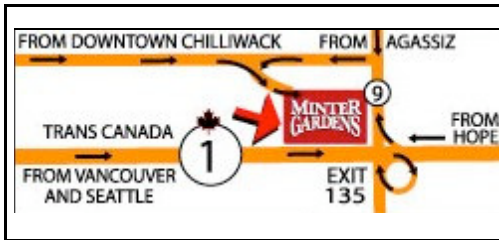

Minter Gardens

- From Domaine de Chaberton, get back to Hwy #1
- Travel east on Hwy #1
- Take exit #135 (Harrison Hot Springs)
- Turn left at round about onto Yale Rd.
- Turn left onto Bunker Rd. and follow to the end
- 52892 Bunker Rd. 604-794-7191

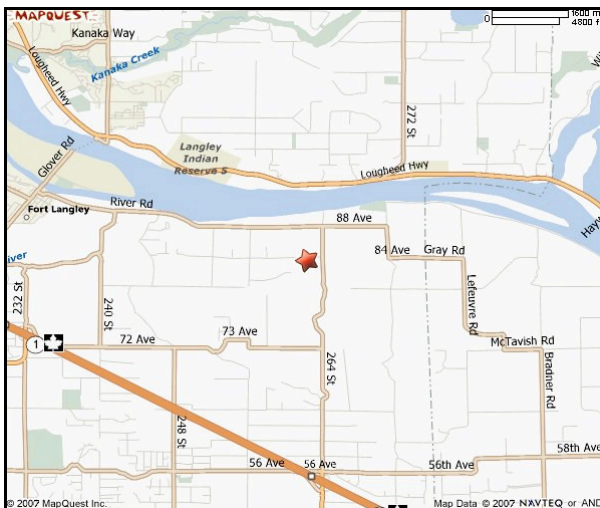

The Fort Wine Company

- From Minter Gardens get back onto Hwy #1
- Travel west on Hwy #1
- Take exit #73 on to 264 Street.
- Turn right onto 264 St. (north) and follow along.
- Turn left onto 84th Ave, the winery is on the right hand side.
- 26151 84th Avenue, Langley, BC 1-866-921-WINE

Fort Langley

- From the Fort Wine Company turn left onto 84th Ave
- Turn left onto 264 St. and follow 264th St.
- Turn left onto 88th Ave and follow into Fort Langley